

OPERATOR'S MANUAL

G4-7 USB

Cordless Hot Melt Glue Gun



EN	OPERATOR'S MANUAL	4
FR	MODE D'EMPLOI	14
DE	BENUTZER-HANDBUCH	26
ES	MANUAL DEL OPERADOR	38
IT	MANUALE OPERATIVO	50

FIG. A



FIG. B - BATTERY CHARGING

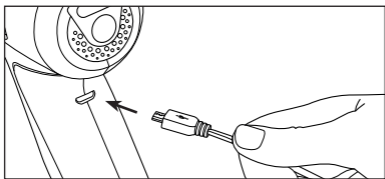
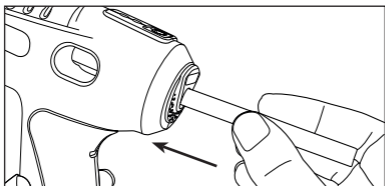
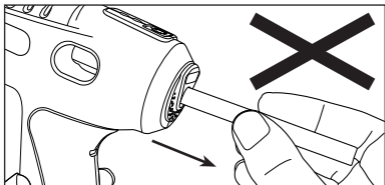

FIG. C - LOADING GLUE STICKS



▲ FIG. D - WARNING



EN 4V Cordless Hot Melt Glue Gun

Congratulations!

On the purchase of your power tool. Your tool will perform to your satisfaction for a long time if handled in accordance with our Safety and Operating instructions.

Save this manual for future reference

Technical data

Tool	4V Cordless Hot Melt Glue Gun
Model type	H4-7 G4-7 USB
Input voltage	4VDC
Glue stick type	Tacwise Type H (7mm diameter) Rapesco Type H (7mm diameter)
Glue stick length	150mm
Heating time	60 seconds approx.
Gluing capacity	2g/min
Weight	239g
Battery	
Battery type	Lithium-ion
Voltage VDC	4VDC
Capacity Ah	1.3Ah
Charger	
Mains voltage/input VAC	100-240V
Battery type	Lithium-ion
Charging time	1-1.5 hrs approx.
Weight	18g

Declaration of Conformity

This power tool has been designed in compliance with the Regulations and Standards of the European Directives, German Product Safety Act, UL and CSA standards.



WARNING! Before use carefully read and understand all instructions. Failure to do so could result in electric shock, fire and/or serious personal injury. The term “power tool” in all of the warnings listed below refers to your battery-operated (cordless) Hot Melt Glue Gun. For any queries relating to safety matters on this power tool, please email service@tacwise.com.

Unpacking

- Carefully remove the power tool and accessories from the outer packaging.
- Inspect the power tool carefully to make sure no breakage or damage occurred during transit.
- If any parts are damaged or missing, please email service@tacwise.com for assistance. Do not operate this power tool until the missing or damaged parts are replaced. Failure to do so could result in a personal injury.
- Whilst every effort has been made to ensure accuracy of information contained within this manual. Our policy is one of continuous improvement to our products and as such we reserve the right to change the product specification without prior notice.

General Safety Instructions

Important. This power tool should not be modified or used for any application other than that for which it was designed. Any such alteration or modification is misuse and could result in a hazardous condition leading to a personal injury. If you are unsure of its relative applications do not hesitate to contact us and we will advise you.

Work Area

- **Keep your work area clean and well lit.** Cluttered benches and dark areas invite accidents.
- **Always work with the adhesive over a protected work surface.**
- **Always use the base as a stand,** never lay the gun on its side or on work surfaces when in use.
- **Keep children and pets away.** All visitors should be kept a safe distance from work area.
- **Avoid dangerous environments.** Do not use power tool in damp or wet locations, or expose them to rain. Provide adequate space surrounding the work area. Do not use in environments with a potentially explosive atmosphere, such as in the presence of flammable liquids, gases or dust; power tools will create sparks which may ignite the dust or fumes.

- **Secure work.** Use clamps or a vice to hold work. This frees both hands to operate the power tool.

Personal Safety

- **Stay alert.** Always watch what you are doing and use common sense. Do not operate a power tool when you are tired or under the influence of medication, alcohol or drugs.
- **Wear proper clothing.** Non-slip footwear is recommended. Contain long hair and roll long sleeves up above the elbow.
- **Do not over reach or use on unstable surfaces.** Keep proper footing and balance at all times.
- **Use safety equipment.** Dust mask, non-skid safety shoes, hard hat, or hearing protection must be used for appropriate conditions. Wear CE approved safety goggles and protective gloves at all times. Normal spectacles only have impact resistant lenses; they are NOT safety goggles.

Electrical Safety

- **Ensure the power tool is switched off and USB cable removed** when not in use or before servicing.
- **Do not expose power tool to rain or wet conditions.**
- **Do not abuse the USB cord.** Never carry the charger by the power cable or pull it with force from the socket. Keep the power cable away from heat, oil, sharp edges or moving parts. Damaged or entangled cords may create a fire or increase the risk of electric shock.

Power Tool Use and Care

- **Do not force the power tool.** Use the correct power tool for your application. It will do the job better and safer at the rate for which it was designed.
- **Always turn the power tool off when not in use.** Leave to cool completely before storing.
- **Store power tools.** When not in use, all power tools should be stored in a dry, locked cupboard and out of the reach of children and other untrained persons.
- **Ensure the tool is switched off and USB cable removed** before making any adjustments or storing the power tool. Such preventive safety measures reduce the risk of starting the power tool accidentally.
- **Do not alter or misuse the power tool.** Use of the power tool for operations different from those intended could result in a hazardous situation.

- **Check for damaged parts.** Check for misalignment or bending of moving parts, breakage of parts and any other condition that may affect the power tools operation. If damaged, immediately discontinue use and ensure the power tool is repaired before using again. Poorly maintained power tools can result in accidents.
- **Maintain power tools with care.** Cables must be checked at regular intervals and replaced if damaged.
- **Recommended accessories.** Use only accessories that are recommended by the manufacturer for your model. Accessories that may be suitable for one tool may create a risk of injury when used on another tool.
- **Keep the power tool and its handle** dry, clean and free from oil and grease for the best and safest performance. Always use a clean cloth when cleaning. Never use brake fluids, gasoline, petroleum-based products, or any strong solvents to clean your power tool. Following this rule will reduce the risk of loss of control and deterioration of the power tool housing.

Battery Tool Use and Care

- **Only use the USB cable specified by the manufacturer.** Use of the wrong charger with the in-built battery may create the risk of a fire.
- **The battery is built into the tool, so cannot be replaced.**
- **Be careful not to short circuit the power tool,** as this may cause a fire.
- **Never leave a power tool unattended whilst charging.**
- **Liquid may leak from the battery under abusive conditions.** Avoid contact. If skin should accidentally come into contact with liquid, flush with water. If liquid should come into contact with eyes seek additional medical help. Liquid ejected from damaged battery may cause irritation or burns.

Specific Safety Instructions

- **Do not insert items into the power tool** other than the glue sticks specified in the manual. Use of accessories that are not designed for this tool could result in personal injury and/or damage to the power tool.
- **Do not touch any parts of the power tool nozzle or adhesive during operation** as they could be hot and cause burns. Hold only by the handle or housing of the tool. If adhesive comes in contact with the skin, immerse in cold water immediately. Do not attempt to remove any adhesive from the skin without proper medical advice.

- **Do not activate the power tool unless it is in contact with the work piece.** Serious injury can result from improper operation.
- **Fastening thin items.** Special caution must be taken for adhering thin items, as this could cause possible harm/burn to anyone or anything behind the work piece or immediate area.
- **Do not repair items that will be used in hot areas or contain hot substances.**
- **When fastening has been completed always ensure the tool is switched off and left to cool.**
- **Never point any power tool at yourself or at any other person.** While working, hold the tool in such a way that no injuries can be caused to the head or to the body.
- **Do not attempt to open the battery pack.** There is a danger of short-circuiting.
- **Protect the battery against heat** (continuous intense sunlight), fire, water and moisture. There is a danger of explosion.
- **Only use the battery which is built into your power tool.**

Model and Serial No.

The model name and serial number of this tool will be found on a label located on the tool's housing. Please record the model name and serial number in the space provided below. Please always give the following information when contacting us:

MODEL NAME.....

SERIAL NUMBER.....

Explanation of Label on Power Tool



Wear CE approved safety goggles at all times



Read instruction manual before use



Dispose of power tool in accordance with environmental legislation



CE: Conforms with EC directives



GS: Conforms with German Product Safety Act



CUS: Conforms with UL and CSA standards

Service

Any servicing requires specialist tools and knowledge and should be performed only by our qualified service engineers or appointed service agent. We strongly recommend that the main housing of the tool is not opened, as such action may result in injury and may compromise the tool warranty.

Features (FIG. A)

1. Nozzle
2. LED charging indicator
3. LED status indicator
4. On/off button
5. Glue stick channel
6. Charging point
7. Trigger
8. LED light

Battery charging (FIG. B)

Use only the USB battery charger that comes with the product. Only the USB battery charger that is matched to the lithium-ion battery should be used in your machine.

- Insert the charging cable into the charging point (6). Plug the USB charger end into a USB plug/USB port. Plug the charger into a power socket. The indicator light on the charger (2) will be red (battery is charging).
- When battery is fully charged (approx. 1-1.5 hrs) the charging indicator (2) will turn green.
- The power tool is now ready to use. Remove the USB charger from the power tool and power source.

NOTE: Charging time will vary depending on input voltage and power source. The USB charging is much more efficient and faster if connected to a mains power outlet.

NOTE: Tool may feel warm during charging.

NOTE: The battery is supplied partially charged. To ensure full capacity of the battery, completely charge the battery before using your power tool for the first time. The lithium-ion battery can be charged at any time without reducing its service life and reaches full capacity after its 5th charge/discharge cycle. The battery supplied is protected, so that it cannot be damaged by exhaustive discharge.

The battery is equipped with an NTC temperature control which allows charging only within a fixed temperature range. A long battery service life is achieved in this manner. Observe the notes for "battery disposal". The LED will flash red if the temperature is too high or low when the battery is charging.

LED Functions of Tool

- Red LED = pre-heating/charging.
- Flashing red LED = battery low/battery temperature is too high or low.
- Green LED = glue gun at correct temperature for use/fully charged.

Loading the Tool with Glue Sticks (FIG. C)

Insert the glue stick into the channel at the rear of the gun (5).

NOTE: We strongly recommend that you only use approved/genuine Type H hot melt glue sticks with this power tool.

Using the Power Tool

- Ensure that a glue stick is loaded.
- Hold the on/off button (4) for 2.5-3 seconds approx.
- The status indicator light (3) will be red, the glue gun is heating up.
- The LED on the glue gun nozzle (8) will also switch on for ease of use.
- The status indicator light (3) will turn green after 60 seconds approx., the glue gun is pre-heated to the correct temperature and is ready for use.
- Squeeze the trigger (7) until adhesive flows from the nozzle.

NOTE: The glue will be hot, there is a danger of harm/burn to anyone or anything that touches the adhesive.

- To ensure continuous flow of glue, insert a further glue stick into the channel (5).
- Apply adhesive to one surface only. Glue need not be spread.
- Press surfaces together within 15 seconds to allow immediate bonding.
- The glue sets firm within 60 seconds.
- To turn the glue gun off, click the on/off button (4) once.
- Remove any surplus glue once cooled, with a sharp knife.

NOTE: Always practice gluing on scrap work pieces before final gluing on projects.

NOTE: Glue that has set on textiles cannot easily be removed.

Warning (Fig. D)



Never attempt to remove a glue stick from the back of the glue gun, as this may cause damage to the heating element of the power tool.

NOTE: The glue gun will automatically switch off after 5 minutes approx. if not used, or if it reaches the automatic cut-off temperature.

NOTE: Allow the glue gun to cool completely before storing.

Maintenance

Your power tool has been designed to operate over a long period of time with a minimum of maintenance. Continuous satisfactory operating depends upon proper tool care and regular cleaning. If the machine should fail despite the care taken in manufacturing and testing procedures, repair should be carried out by our service engineers or appointed service agent. In all correspondence and spare parts order, please always include the serial number given on this machine.

Cleaning

Keep the nozzle clear and regularly clean.

Lubrication

This tool requires no lubrication. Do not lubricate the tool, as it will damage the internal parts.

Product Advice and Technical Support

What to do if you have a problem with your power tool?

Email service@tacwise.com.

Transport

The contained lithium-ion batteries are subject to the Dangerous Goods Legislation requirements. The user can transport the batteries by road without further requirements.

When being transported by third parties (e.g. air transport or forwarding agency), special requirements on packaging and labelling must be observed. For preparation of the item being shipped, consulting an expert for hazardous material is required. Dispatch batteries only when the housing is undamaged. Tape or mask off open contacts and pack up the battery in such a manner that it cannot move around in the packaging. Please also observe possibly more detailed national regulations.

Unwanted Tools

Recycle unwanted materials instead of disposing them as waste. All tools and packaging should be sorted, taken to the local recycling centre and disposed of in an environmentally safe way. Alternatively, please email service@tacwise.com for details on how to dispose of your power tool free of charge in an environmentally friendly manner.

Battery Disposal

Follow your Local Authority procedures for the disposal of Lithium-ion battery packs.

Guarantee

Our power tools are carefully checked, tested and are subject to the stringent controls of Quality Assurance. We therefore offer the following guarantee for our power tools. Your warranty claim based on your sales contract with the retailer, including your statutory rights, shall not be affected by this guarantee.

One-Month Guarantee

If you are not completely satisfied with the performance of your power tool or it is faulty or damaged on purchase then we will exchange the product or issue a full refund within 28 days of purchase. Proof of purchase must be produced with an original receipt and the tool must be returned complete as purchased to the point of purchase. This does not affect your statutory rights.

One-Year Free Servicing

If your power tool requires maintenance or servicing in the 12 months following purchase, it will be undertaken free of charge by a our service engineers. Proof of purchase must be produced with an original receipt. This includes labour and spare parts for the tool. However in some cases the most economical option will likely be a replacement service exchange unit supplied by us. Accessories such as batteries, fasteners etc. are excluded.

Two-Year Standard Warranty

Should your power tool become defective due to faulty materials or workmanship within 24 months from the date of purchase, we guarantee to replace all defective parts free of charge or at our discretion, replace the tool free of charge. This warranty does not cover:

- Tools that have received unauthorised changes or additions.
- Defects caused by using accessories, components or spare parts other than approved/genuine manufacturer's accessories or parts.
- Component parts that are subject to natural wear and tear caused by use in accordance with our operating instructions.
- Defects to the tool caused by improper use, abnormal environmental conditions or inappropriate operating conditions, non-compliance with our operating instructions or insufficient servicing or maintenance.
- Proof of purchase must be produced with an original receipt.

For details of your nearest service engineer, please email service@tacwise.com, or to register your warranty visit www.tacwise.com/warranty-registration

